

## MaxiCOM MK808

When it comes to ultra-portability, MaxiCOM MK808 is your perfect companion. Installed with a fast quad-core processor, MK808 offers maximum convenience and swift diagnosis. The intuitive user interface makes using the device effortless through a 7-inch LCD touch screen that displays at 1024x600 quality.

## TOP 5 REASONS TO GET MaxiCOM MK808

- ❖ **EASY-TO-USE:** Once accessed to the Diagnostics service of MaxiCOM MK808, here are a variety of functions available including oil reset and EPB/BMS/SAS/ DPF service which are used for the safety and efficient maintenance of systems.
- ❖ **COST-EFFECTIVE:** Compared with those at similar price, this automotive diagnostic scanner supports basic IMMO functions and TPMS Service, including displaying sensor IDs from vehicle's ECU, inputting TPMS sensor replacement IDs and registering sensors to vehicle.
- ❖ **USER-FRIENDLY:** This is a tablet diagnostic scanner with 7" touchable screen and enables sensitive response with fast quad-core process; Moreover, with Wi-Fi connection there is no USB or card reader needed for updating software (one-touch updates)
- ❖ **WORRY-FREE:** Provide you with 12-month warranty for any quality problems and 12-month free updates and newly added parameters and car models
- ❖ **Multi-language.** Free to exchange language now. You need to offer the customer service SN

## AUTEL MaxiCOM MK808 FEATURES

- ❖ Support IMMO functions.
- ❖ Support TPMS sensor relearn.
- ❖ Reset Steering Angle Sensor (SAS).
- ❖ Support battery registration and reset.
- ❖ Read/clear codes for all available systems.
- ❖ Reset service mileage and service intervals.
- ❖ Relearn parking brake pad after replacement.
- ❖ Support forced DPF regeneration and adjusting injectors.
- ❖ Display live data in text, graph & analog for easy data review.
- ❖ Auto VIN technology can automatically identify the vehicle's make, model and year information in no time.



# FULL SYSTEM DIAGNOSES

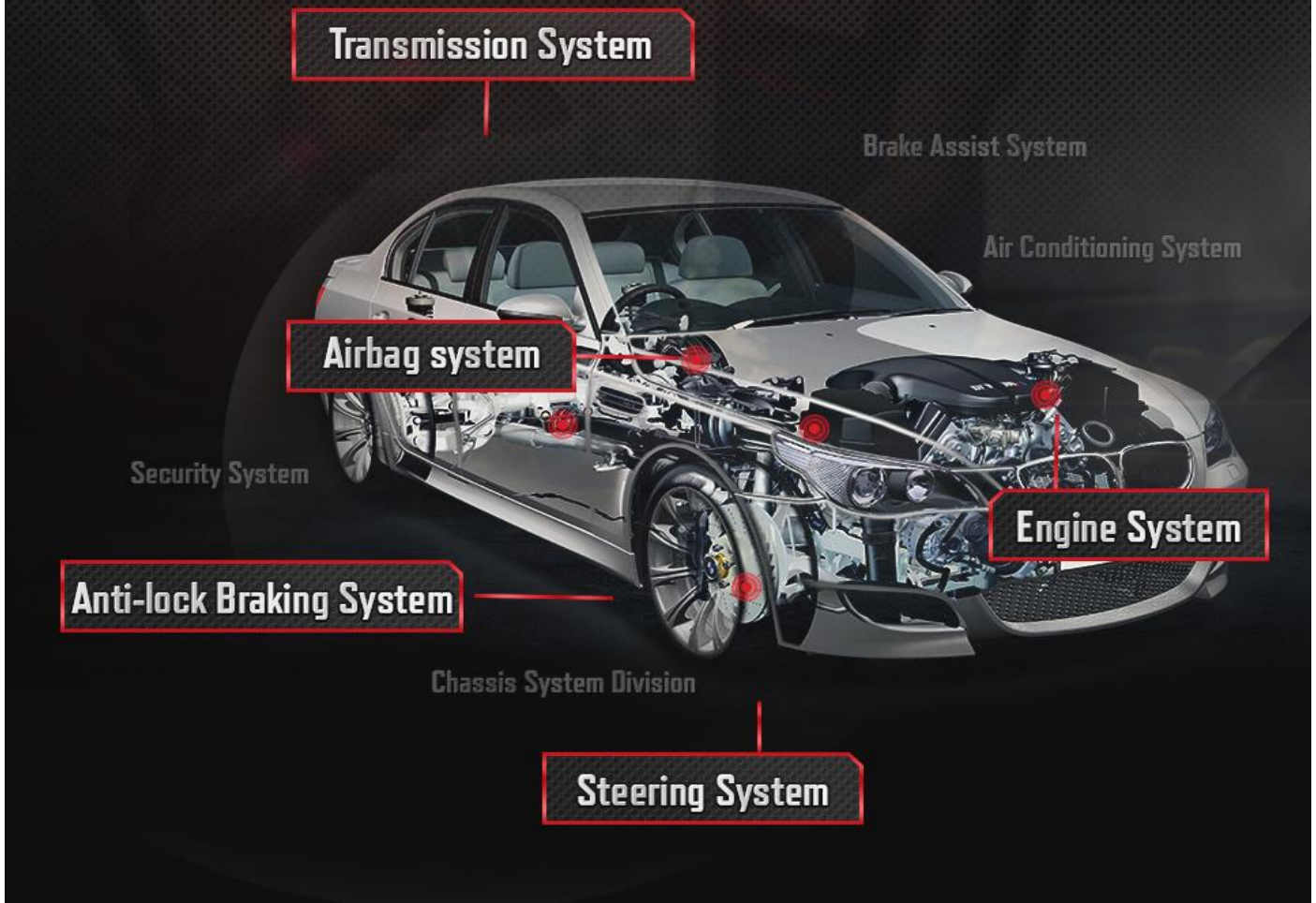

Read Codes / Erase Codes / Live Data / Freeze Frame



- ❖ **Read and erase codes** for all available systems using the supported protocols. The tablet type MaxiCOM diagnostic tool is the best way to display live data in text, graph & analog for easy data review
- ❖ To **diagnose Brake System** if you feel the brake pedal is mushy and notice unusual odor or noise, etc. A properly operating brake system is critical to ensure safe vehicle control and operation;
- ❖ To diagnose **Emission System** if the system is affected by vehicle age or poor quality fuel. A good emission system reduces harmful gases to a large degree and protects you from being fined;
- ❖ To diagnose **Fuel system** if vehicle won't start or "Check Engine" light is illuminated. Check car's fuel system regularly ensures the best performance of your car with the lowest emissions;
- ❖ To diagnose **Transmission** if your car is slipping or difficult to shift. The system plays an important part in the overall performance of your car;
- ❖ To diagnose **Wiper System** if you observe chattering or streaking wiper. If the car is not regularly checked, the accident might happen because you can't see clearly;
- ❖ To diagnose **Light System** if you see rapid signal blinking or dimming lights.

# 19 Kinds of Special Reset Service Functions

## 19 SPECIAL SERVICES FUNCTIONS

 Oil reset	 EPB	 TPMS	 BMS	 Brake bleed	 CHG tire size
 DPF	 Immo keys	 Injector	 SAS	 Suspension	 TEC learn
 Throttle	 WIN DR ROOF	 Seats	 Odometer	 Lang change	 Trans adaption
 Headlamp					



**Oil Reset Service** allows you to perform reset for a new calculation of Engine Oil Life system once changed the oil.

**EPB service** is important in the maintenance of electronic braking system's safety and efficiency.

**BMS service** allows the scan tool to evaluate the battery charge state, monitor the close-circuit current, register the battery replacement, and activate the rest state of the vehicle.

**DPF service** specially works for Diesel Particulate Filter system with DPF regeneration, DPF component replacement teach-in and DPF teach-in after replacing the engine control unit.

**SAS service** helps clear the fault steering angle sensor memories and plays an important role in the steering angle sensor calibration.

**TPMS service** makes sense in displaying sensor IDs from the vehicle's ECU, inputting TPMS sensor replacement IDs and testing sensors.

**IMMO** the unique function Autel MaxiCOM MK808 has at this price, is mainly used to disable the lost vehicle keys and program a new replacement key fob.

**ABS Bleeding** ABS brake bleeding to get a firm brake pad after air exhaustion.

# The MaxiCOM diagnostic system supports 4 methods for Vehicle Identification.

## 4 METHODS FOR VEHICLE IDENTIFICATION

### 1 Auto VIN Scan

You can choose the Auto VIN function to scan all systems of all detected vehicles or tap control unit to access a specific system for diagnosis.



### 2 Manual VIN Input

For vehicles not supporting Auto VIN function, you can manually input the VIN code of the tested car for further diagnosis.



### 3 Automatic Selection



### 4 Manual Selection

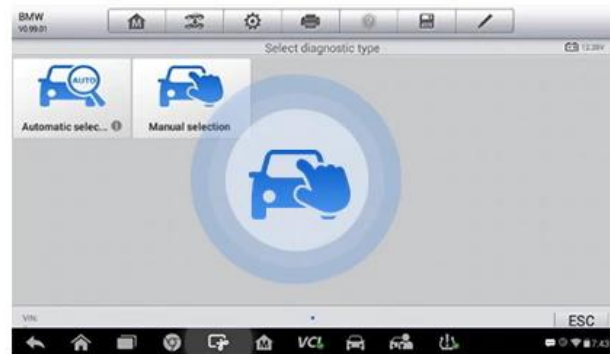

#### 1. Auto VIN Scan

The MaxiCOM diagnostic system features the latest VIN-Based Auto VIN Scan function to identify vehicles and scan all the diagnosable ECUs and run diagnostics on the selected system. This function is compatible with 2006 and newer vehicles.

#### 2. Manual VIN Input:

For vehicles not supporting the Auto VIN Scan function, you may manually enter the vehicle VIN.

#### 3. Automatic Selection:

The Auto VIN Scan can be selected after selecting the test vehicle manufacturer.

#### 4. Manual Selection:

When the vehicle's VIN is not automatically retrievable through the vehicle's ECU, or the specific VIN is unknown, the vehicle can be manually selected.

# Complete OBD2 functions

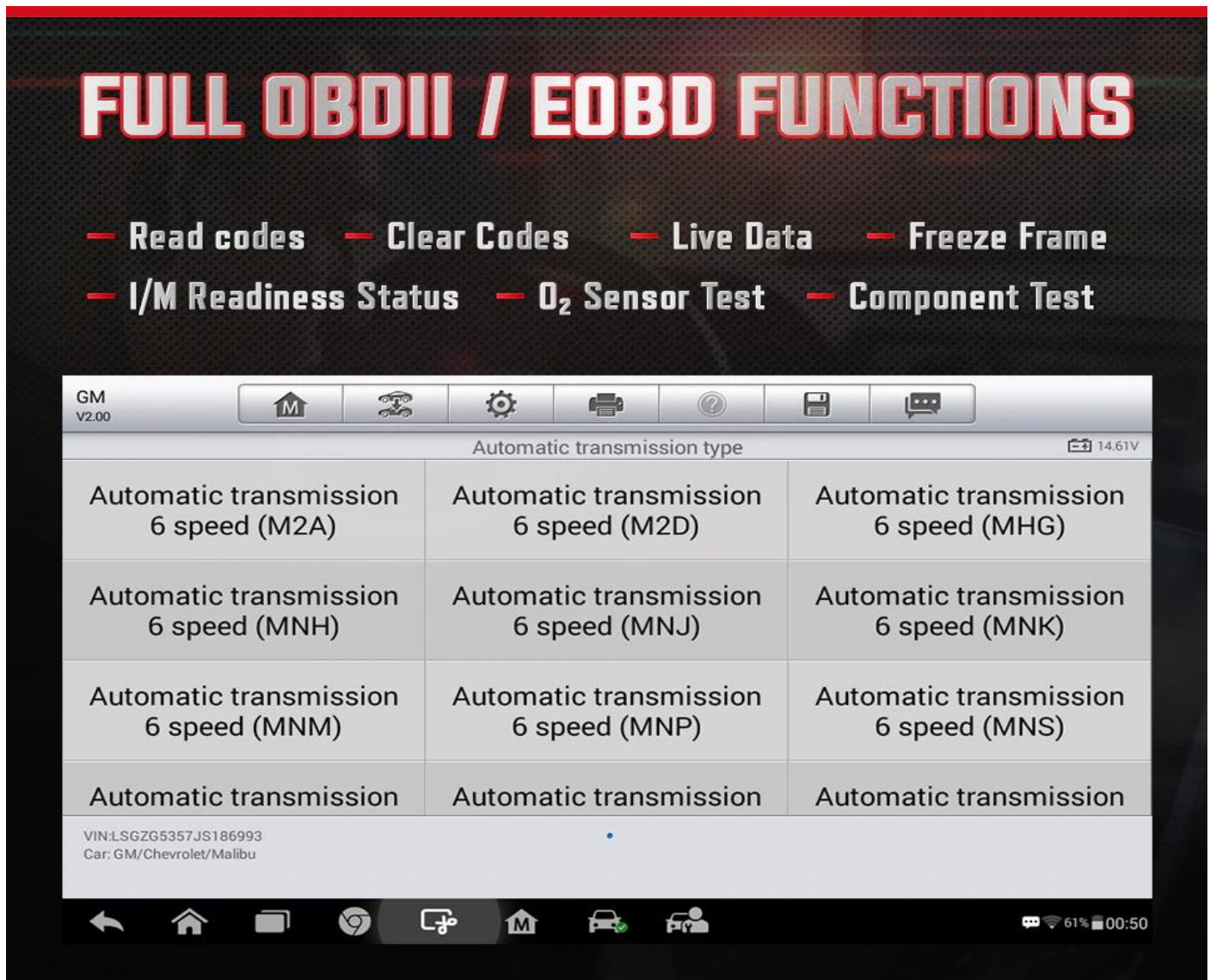

**Reading Codes:** Show the detailed description of the Diagnostic Trouble Code (DTCs)

**Erasing Codes & Reset:** Turns off Check Engine Light (MIL), clears codes and resets monitors.

**Data Stream:** Reads and displays live ECU/PCM data stream, plotting functions graphically and stores freeze frame data.

**I/M Readiness Status:** Shows whether the various emissions-related systems on the vehicle are operating properly and are ready for inspection and maintenance testing.

**Read Live Data Stream:** Show the information of continuous data stream from a vehicle in live graphic (waveform) display.

**View Freeze Frame Data:** Check the certain vehicle conditions which are recorded by the on-board computer at the time the emission-related fault occurs.

**O2 Sensor Test:** Allows retrieval and viewing of O2 sensor monitor test results for the most recently performed tests from the vehicle's on-board computer.

**On-Board Monitor Test:** Retrieves and displays test results for emission-related powertrain components and systems.

**Read Vehicle Information:** Display the information such as VIN (Vehicle Identification Number), CID (Calibration ID) and CVN (Calibration verification number), etc.



# SPECIFICATIONS

## MaxiCOM MK808 Specification:

Recommended Use	Indoor
Operating System	Android™ 4.4.4
Processor	Cortex-A9 processor (1.5 GHz)
Memory	32GB
Display	7-inch LCD capacitive touchscreen with 1024x600 resolution
Connectivity	Mini USB 2.0
	USB 2.0
	Wi-Fi
	Micro SD card (supports up to 32GB)
Sensors	Ambient light sensor for brightness auto adjust
Audio Input/Output	Input: N/A
	Output: Beep
Power and Battery	3.7 V/3200 mAh lithium-polymer battery
	Charges via 5 VDC power supply
Tested Battery Life	Around 4.5 hours of continuous use
Battery Charging Input	5 V/1.5 A
Power Consumption	500 mA (LCD on with default brightness, Wi-Fi on) @3.7 V
Operating Temp.	0 to 55°C (14 to 131°F)
Storage Temp.	-20 to 60°C (-4 to 140°F)
Operating Humidity	5% - 95% non-condensing
Dimensions (W x H x D)	237.8 mm (9.4") x 148.6 mm (5.9") x 35.5 mm (1.4")
Net Weight	788 g (2.42 lb.)
Supported Automotive Protocols	ISO9141-2, ISO14230-2, ISO15765, K/L-Line, Flashing Code, SAE-J1850 VPW, SAE-J1850 PWM, ISO11898(Highspeed, Middlespeed, Lowspeed and Singlewire CAN, fault-tolerant CAN), SAE J2610, GM UART, UART Echo Byte Protocol, Honda Diag-H Protocol, TP2.0, TP1.6

